



1-1/8"x10" Double End Stud

6321810

Units Inch[mm]

Scale 1 / 4

Drawn Shannon Kimes

Date 3/21/2026

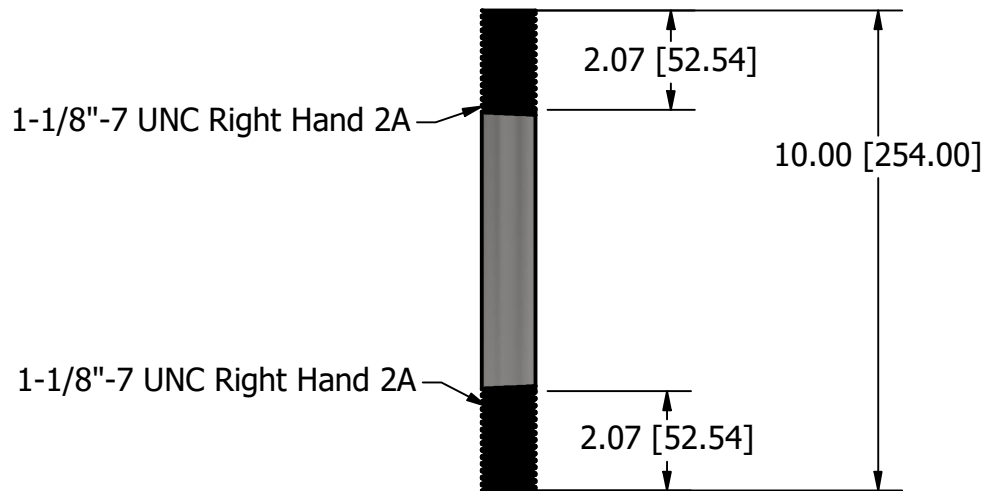
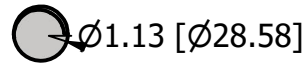

Material		Packaging		Notes
Base Material: Steel, Carbon		Weight lbs[kgs]	Units	1. Weights approximation/theoretical.
Finish: Plain/None	Piece	2.82[1.28]	1 Piece	
Coating: Oiled	Bag	50[23]	18 pcs	
	Pallet	2500[1134]	50 Bags	
	Ton[MT]	2,000[1,000]	710[781] pcs	